

Auto Power Relay



CHINT® Automotive is an automotive relay manufacturer and supplier in China. We have been specialized in automotive relay over twenty years. CHINT® Auto Power Relay is developed for the large current demand.

Our products supplies for almost all brand of Chinese truck, Daimler & John Deere with OEM quality and competitive price. We look forward to becoming your long-term partner in China.

	Auto Power Relay	Product Specification Intro
		JD01/J/T/K Series
Description		
<p>CHINT® Auto Power Relay are used in fuse box or relay box of the vehicle. Two large pins of P87 and P30 are for large power. Commonly used for air condition, front light, motors, pre-heating system etc.</p> <p>High current relay for some special usage such as pre-heating, starting, which can up to 80A in rated current under either 12V or 24V.</p>		
Electrical Specification		Application:
Rated Working Voltage: 12V/24V		
Rated Current: 70-80A		
Normally Open (N/O) / Convert (CVT)		
Isulation Resistance ≥ 100MΩ (500VDC)		
Pull-in Voltage: ≤ 8.5V or 17V		
Release Voltage: ≥ 1.2V or 2.4V		
Life Endurance: 100,000 cycles		
Working Temperature: -40°C - 65°C		
Accord with RoHS, ELV, QC/T413-2002		
Mounting Diagram:		Electrical Diagram:

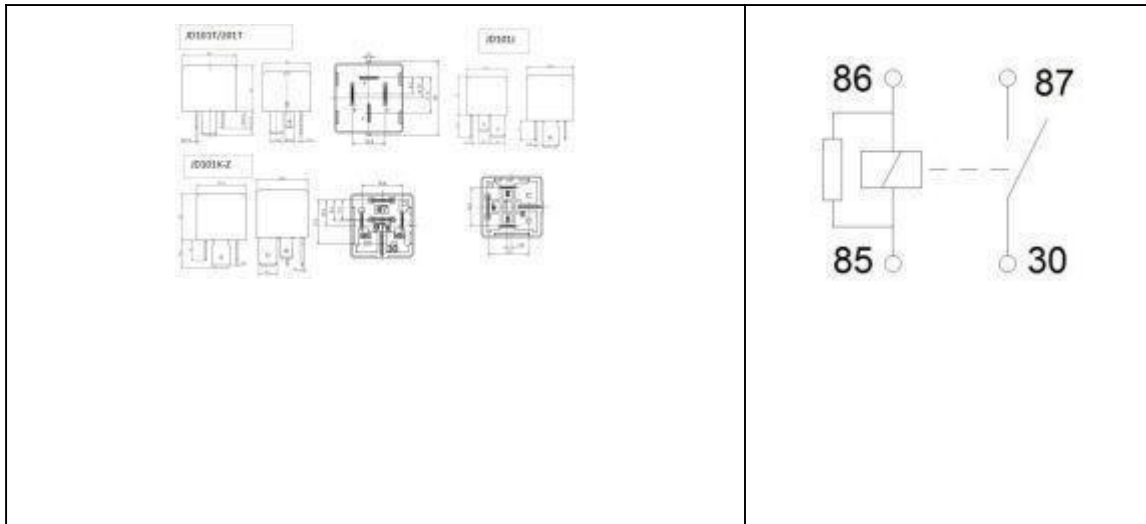

Ordering Informaton:

Model	Elec-Spec.	Appearance	Performance	Contact Feature
JD101T	12V,80A		Resistor	4P, N/O
JD201T	24V,80A		Resistor	4P, N/O
JD101J	12V, 70A	Metal BK	Resistor	4P, N/O
JD201J	24V, 70A	Metal BK	Resistor	4P, N/O
JD101K-Z	12V, 70A/40A	Metal BK	Resistor	5P, CVT